

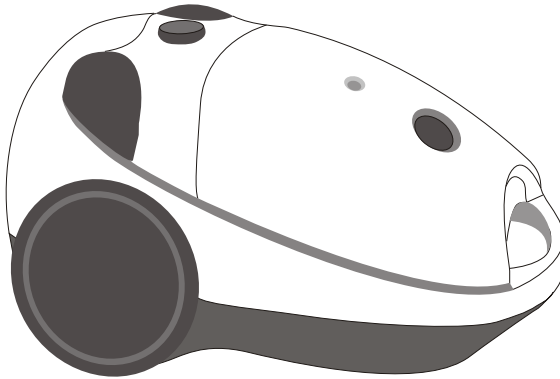

INSTRUCTION MANUAL

SC164R/185R

VACUUM CLEANER



Please Read The Instruction Manual Carefully Before Use
Save these instructions

CONTENT

Important Safeguards	1
Parts Name and Operation Instruction	2-3
Dust Bag	4
Maintenance of The Filter	5
Technical Specification	5

Important Safeguards

When using an electrical appliance, basic precautions should always be followed, including the following.

READ ALL INSTRUCTIONS BEFORE USING THIS VACUUM CLEANER

WARNING -to reduce the risk of fire, electric shock or injury:

1. Do not leave the vacuum cleaner when plugged in. Unplug it from the outlet when not in use or before servicing.
2. Do not use outdoors or on wet surfaces.
3. Do not allow it to be used as a toy. Close attention is necessary when used by or near children or infirmed persons.
4. Use only as described in this manual. Use only the manufacture`s recommended attachments.
5. Do not use with a damaged cord or plug. If the vacuum cleaner is not working as it should, or if it has been dropped, damaged, left outdoors or dropped into water, return it to a service center.
6. Do not pull or carry by the cord, use the cord as a handle, close a door by the cord, or pull the cord around sharp edges or corners. Do not run the vacuum cleaner over the cord. Keep the cord away from heated surfaces.
7. Do not unplug by pulling on the cord. To unplug, grasp the plug, not the cord.
8. Do not handle the plug or the vacuum cleaner with wet hands.
9. Do not put objects into the openings. Do not use with any openings blocked, keep free of dust, lint, hair and anything that may reduce air flow.
10. Keep hair, loose clothing, fingers and all the parts of your body away from openings and moving parts.
11. Do not pick up anything that is burning or smoking, such as cigarettes, matches or hot ashes.
12. Do not use without dust compartment and/or filters in place.
13. Turn off all controls before unplugging.To rewind the cord,grasp the plug.
14. Use extra care when cleaning on stairs.
15. Do not use to pick up flammable or combustibile liquids such as gasoline, or use in areas where they may be present.
16. Do not place any heavy items on top of the vacuum cleaner.
17. Do not step on the hose or pull it too strongly.
18. Do not pick up items such as pieces of waste paper or cloth which look as though they may cause the hose to become blocked.
19. Do not clean or store the vacuum cleaner in places where there are high temperatures.
20. Store the vacuum cleaner away from excessive humidity.
21. When carrying the vacuum cleaner, hold it by the carrying handle.
22. Before servicing the vacuum cleaner, allow all metal parts to cool first.
23. If the supply cord of this appliance is damaged, it must only be replaced by a service centre pointed by the manufacturer, because special purpose tools are required.

Parts Name and Operation Instruction



Crevice nozzle

Used for cleaning gaps, corners, and weatherboarding and between cushions.



Upholstery brush

Used for cleaning sofa, curtain or dust on the decorating surfaces.

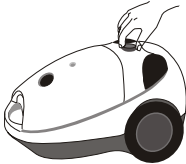

Speed controller

Twist knob to adjust the power level.



To connect the hose: Insert the hose into the opening. Rotate to the right.
To disconnect the hose: Rotate to the left and pull out the hose.

Cord winder

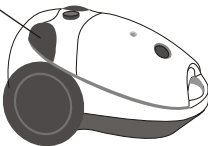

Power cord winding

Please take care when retracting the cord. Pull the plug out of the socket, hold the plug and press the cord winder knob.

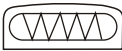

Dust indicator

When the dust indicator turn red, it maybe cause by

A: Air inlet is blocked, you should check the appliance ;

B: The dustbag is full, you should replace the paper dustbag or empty the cloth dustbag.:

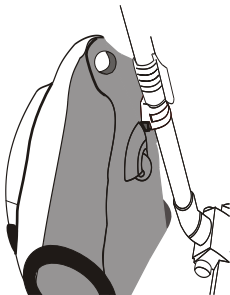

Storage

The crevice tool can be held on the extension tube; push the holder to the extension tube firmly along the curve of the holder then insert the crevice tool on the groove of the holder. Attach the lower tube to the vacuum cleaner.

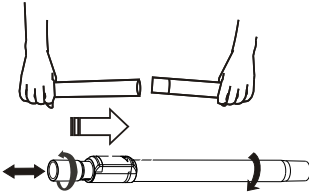

When using extension tube(SC164R) insert the coupling into the bigger hole of the connecting tubes then swivel it to firm connection.
When using telescopic tube(SC185R)rotate the tube to extend or shrink the tube.

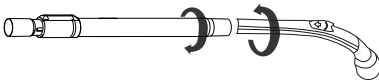

When connecting please rotate them so that they can fit tightly together.

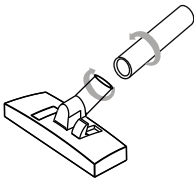

Carpet-floor nozzle
When connection please rotate them so that they can fit tightly together.

CAUTIONS: The vacuum cleaner equip with thermal cut off, if it stops working suddenly, turn off the appliance and after 30 minutes it can work normally, if it can not work please ask the appointed service center.

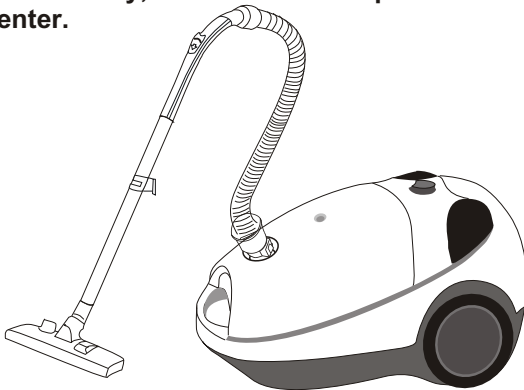

Dust Bag

1. Never use the appliance without dust bag.
2. Replace the dust bag once it is damaged.
3. Clean cloth dust bag termly to assure long life.
4. Switch the appliance OFF before replacing dust bag.

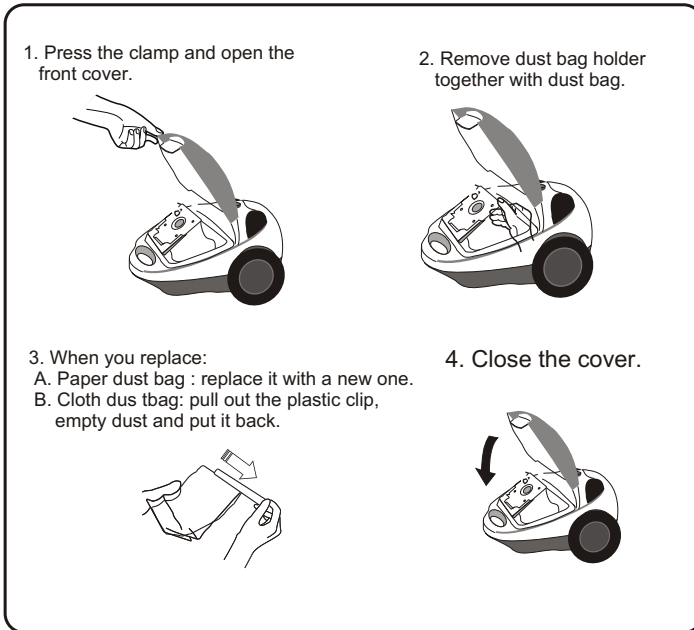

Note: It is impossible to close the cover when no dust bag inserted.

Maintenance of The Filter

1. Clean the filter more than two times one year. It shall be cleaned when visible dust appears.
2. Switch the appliance OFF and pull out the plug from the socket before replacing the filter.

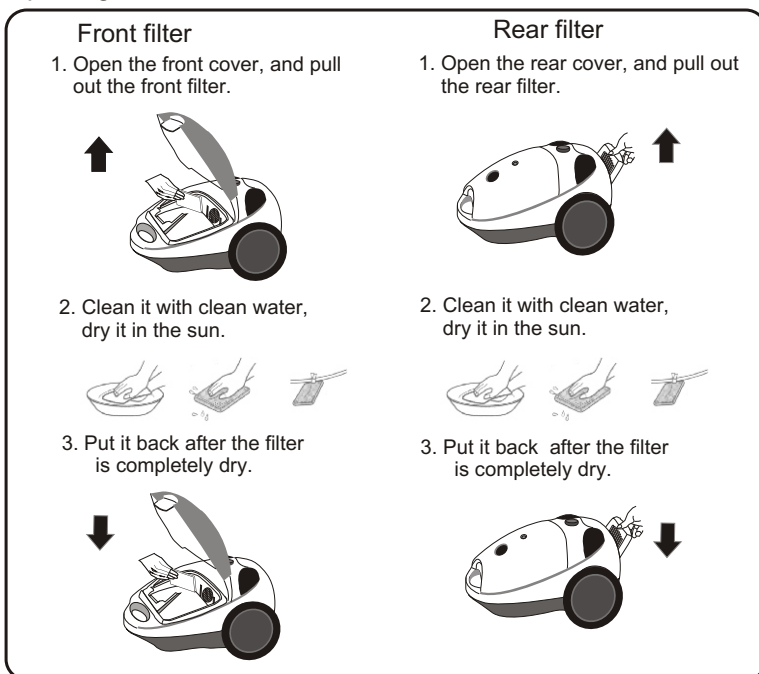

Caution:

1. Never use this appliance without filter.
2. Never clean the filter with washing machine, and never dry it with hair dryer.

Technical Specification

Model Number	SC164R/185R
Vacuum	18 k Pa
Noise	≤ 80dB(A)
Voltage	230-240V~50Hz
Input Power	1600W/1800W Max
Power Control	On Unit
Dust Bag Capacity	4L

SANYO

SANYO Electric Co., Ltd.

Made in China